

Advanced Technology.  
Proven Design.



## Model BT Rotary Valve

### Engineered to Increase Productivity

#### Standard Features:

The Model BT Rotary Valve handles demanding powder-handling tasks, combining durability and precision to ensure consistent, efficient operation.

- ▼ **Heavy-Duty Construction:** Rated for 15 PSIG internal and differential pressure, with cast or fabricated bodies in iron, carbon steel, or stainless steel.
- ▼ **Compact Design:** Ideal for low-headroom setups, enabling efficient powder feeding in space-constrained environments.
- ▼ **Precision Shaft Seals:** Equipped with Kevlar-impregnated PTFE packing for a tight, reliable seal.
- ▼ **Flexible Connection:** Available with round or square inlet flanges and pipe or tubing connections.
- ▼ **Temperature Tolerance:** Standard designs handle up to 250°F.



Learn  
more at  
[younginds.com](http://younginds.com)

## Model BT Rotary Valve

### Unmatched Performance for Challenging Applications

The Model BT Rotary Valve excels in handling cohesive powders that pack or resist discharge in conventional setups. Its blow-thru design utilizes convey line velocity to sweep powders cleanly from rotor pockets, maintaining smooth, uninterrupted flow. Engineered for durability and adaptability, the valve is available in configurations to handle high pressures, high temperatures, and specialized materials, making it ideal for diverse industries and demanding processes.

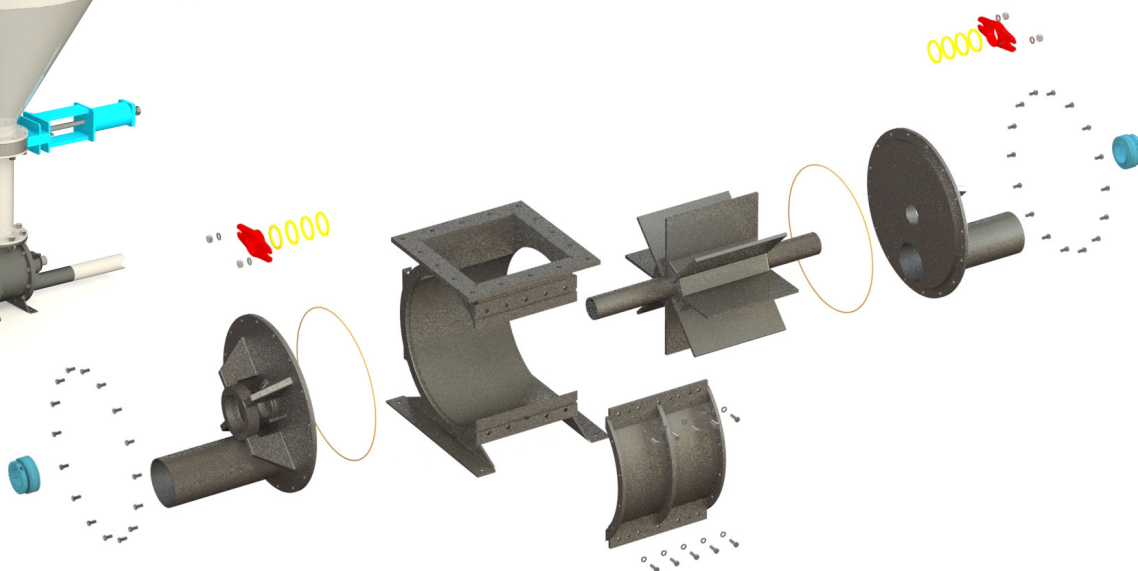

### Optional Features:

Tailor the Model BT Rotary Valve to meet your unique requirements with a wide range of optional features:

- ▼ **High-Pressure and High-Temperature Designs:** Rated for up to 350 PSIG or 1600°F.
- ▼ **Enhanced Materials:** Choose from Hastelloy, Titanium, Inconel, or engineered plastics for specialized applications.
- ▼ **Abrasion and Release Coatings:** Options include hard chrome, nickel plating, or Teflon for enhanced durability.
- ▼ **Advanced Sealing Options:** Lantern rings, purge connections, and mechanical seals ensure superior performance.
- ▼ **Inspection and Maintenance:** Side access panels and replaceable rotor tips simplify upkeep.
- ▼ **Custom Polishes and Finishes:** Interior and exterior coatings available to meet application and aesthetic needs.