

ITEM NO.	DESCRIPTION	QTY.
1	SHOULDER BOLT, 3/8"	4
2	SPRING, LEE SPRING	4
3	AIR CYLINDER	6
4	PUSHER PLATE	2
5	RING, PACKING	6
6	R.V. LANTERN RING	2
7	PACKING FOLLOWER	2
8	WASHERS, FLAT, 1/2"	4
9	NUTS, HEX, JAM, 1/2"-13UNC	4
10	BEARING	2
11	MUFFLER, QUIETAIRE,	6
12	END SEAL PACKING	2
13	WASHERS, LOCK, 3/8"	25
14	BOLTS, HEX HEAD, 3/8"-16UNC	25

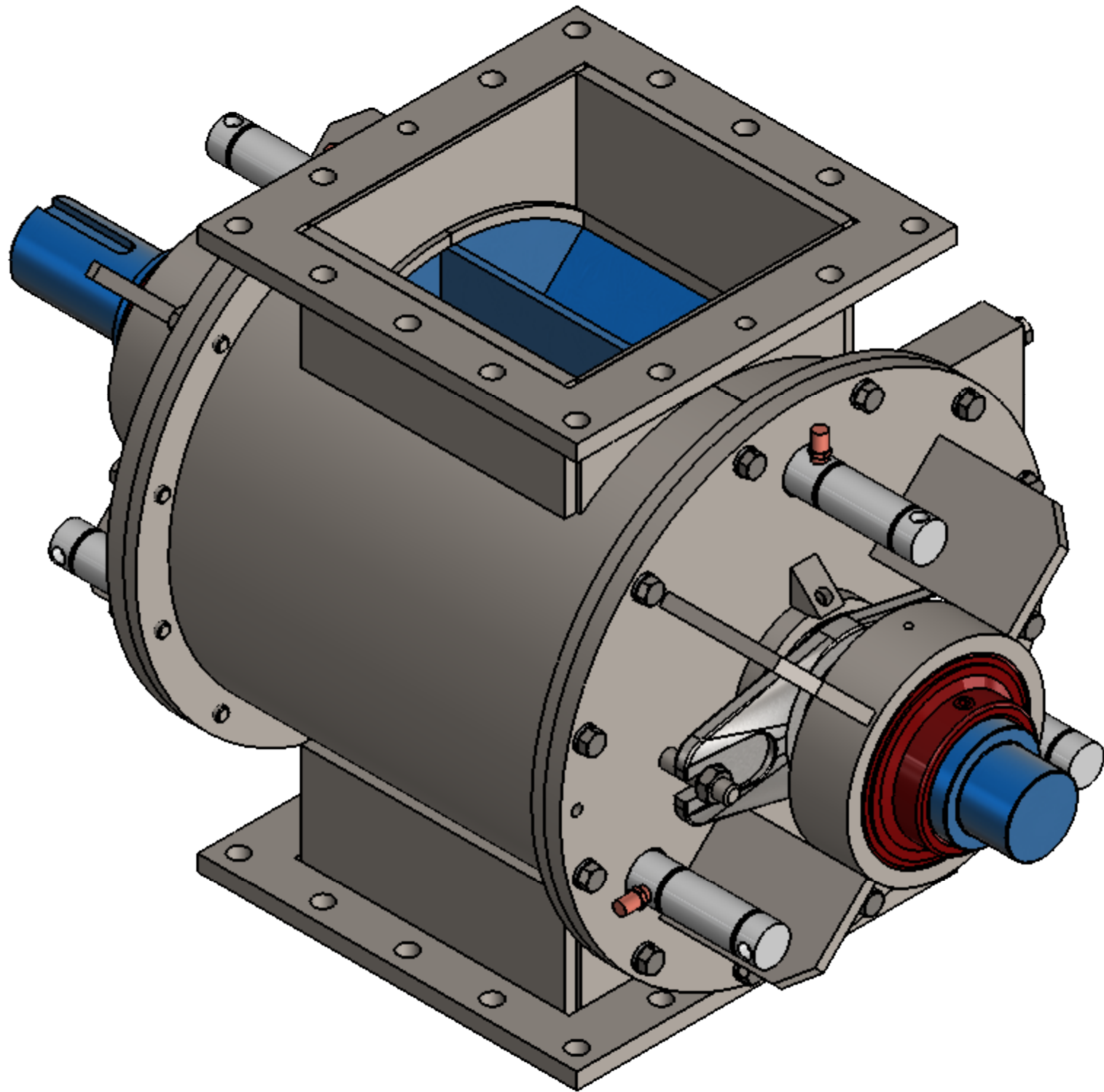
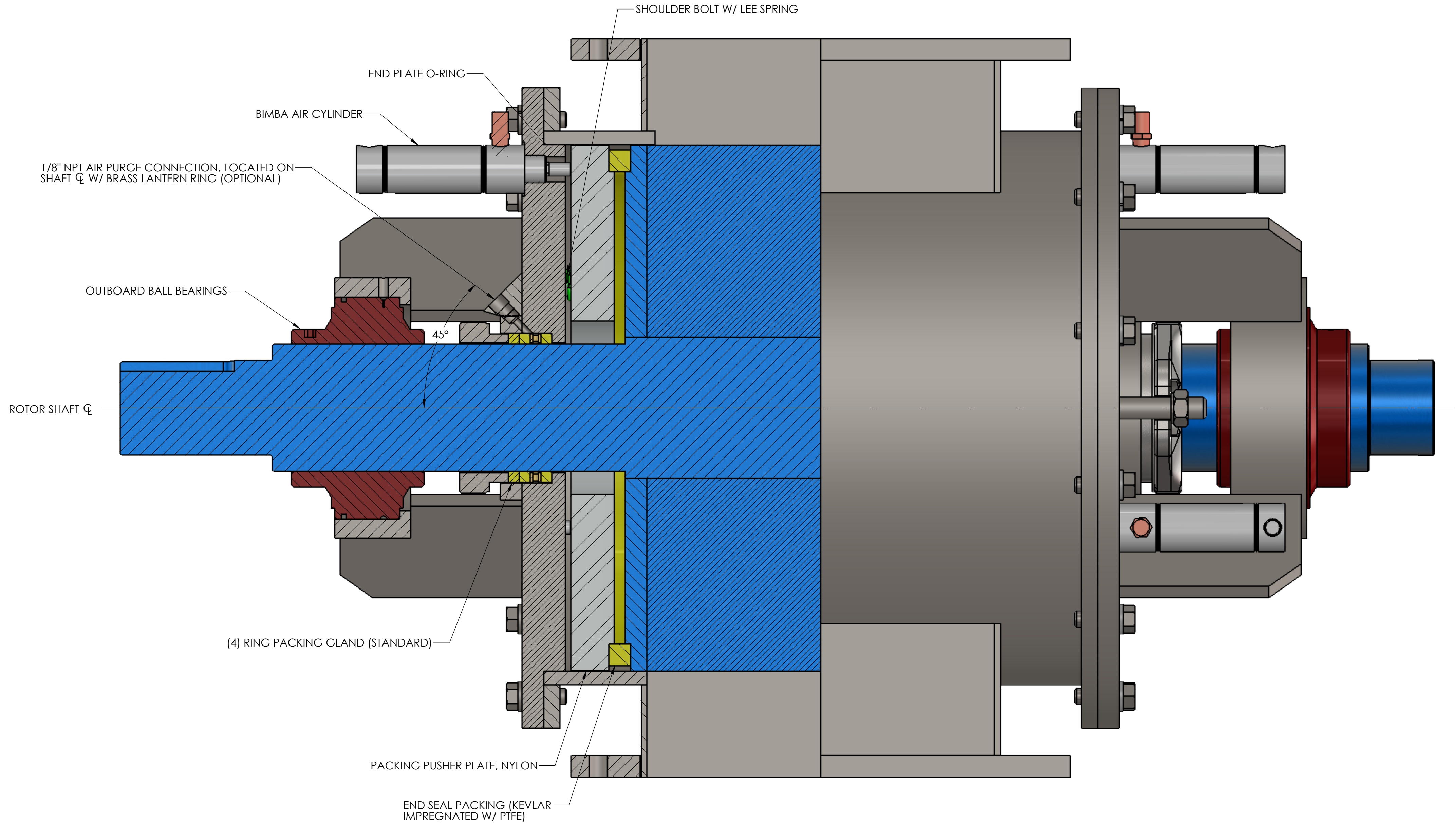

UNIT WEIGHT
382.21 LBS

GENERAL TOLERANCES
UNLESS OTHERWISE SPECIFIED THE FOLLOWING SHALL APPLY
MACHINING - .XX= .02 .XXX= .005 ANGLE= .50°
SURFACE ROUGHNESS HEIGHT 63 MICROINCHES OR LESS
FABRICATION - UNDER 6 6 TO 24 24 TO 60 OVER 60
± .06 ± .12 ± .19 ± .25
UNLESS OTHERWISE SPECIFIED DIMENSIONS ARE IN INCHES

REV. NO.	DESCRIPTION	DATE	BY
REVISIONS			
CUSTOMER:			
CUSTOMER PO NUMBER:			
YOUNG JOB NUMBER:			
TITLE			
YOUNG INDUSTRIES MODEL 'HC-ES' END SEAL ROTARY VALVE			
THE YOUNG INDUSTRIES, INC. MUNFCT, PENNSYLVANIA 17756 TELEPHONE: 570-546-3165			
DRAWN BY: BMF		DATE DRAWN:5/16/18	
CHECKED BY:		SCALE=2:3	
DRAWING NUMBER		SHEET 1 OF 1	REV: 00
S-2-8248			